









-  interphone
-  PC 10/16A en plinthe
-  PC 10/16A à + 1.10m
-  PC 20AT en plinthe
-  PC 32AT en plinthe
-  interrupteur simple allumage
-  interrupteur va et vient
-  plafonnier
-  réglette ou bandeau lumineux
-  radiateur
-  téléphone
-  télévision

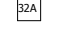
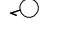

CAEN

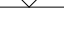
"L'orée de Beaulieu"

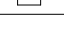
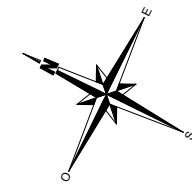
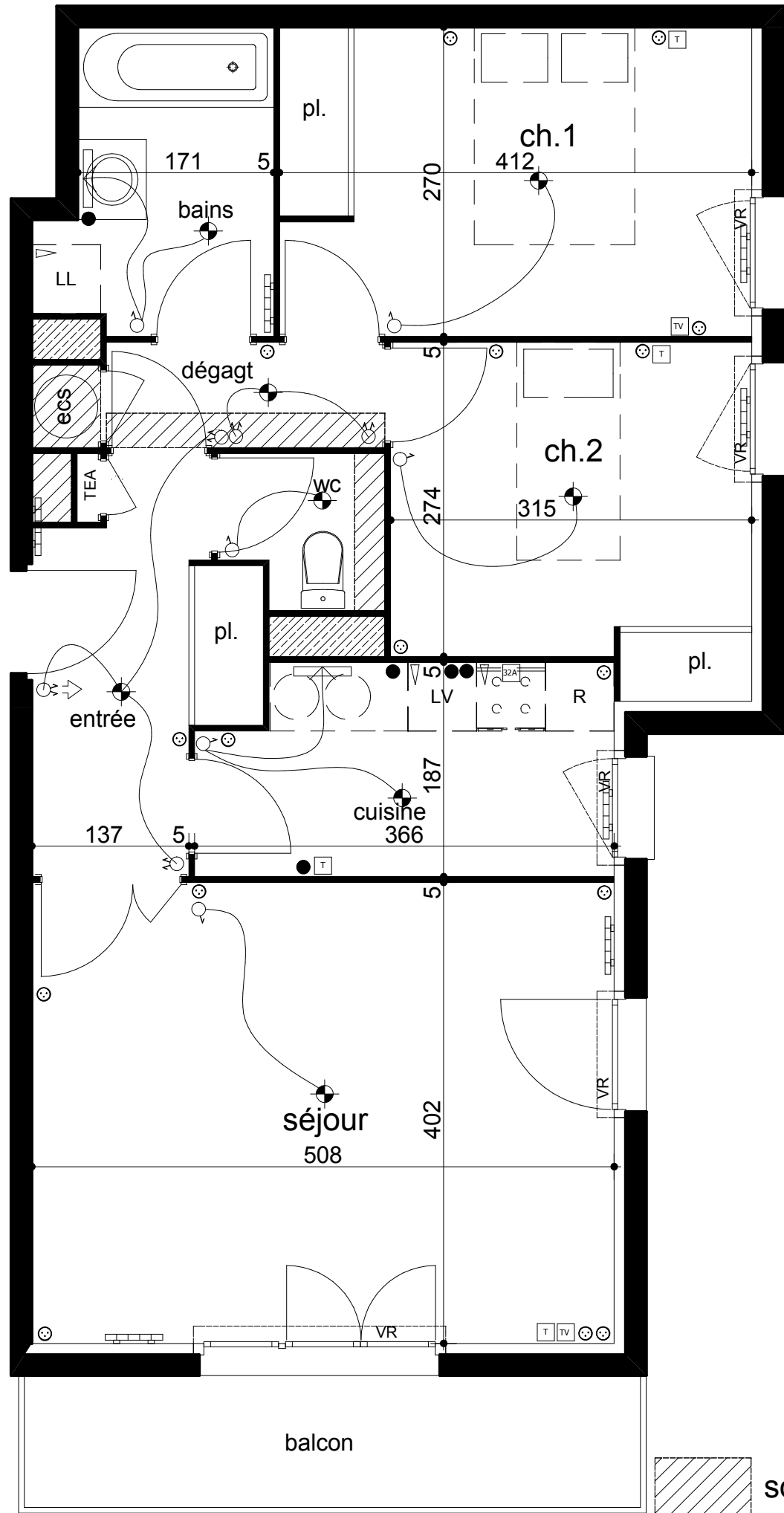
Rue du chemin des poissonniers

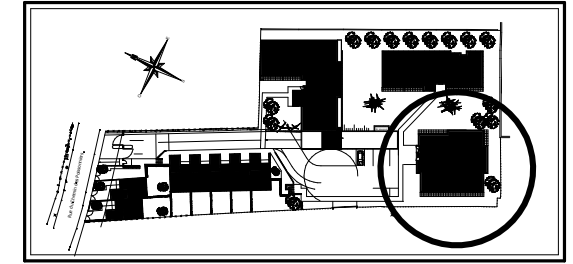

Appartement n°233
Etage 3
type T3 62.15m²



SURFACE HABITABLE	
SEJOUR	20,42 m2
CUISINE	6,45 m2
WC	1,93 m2
ENTREE+PL	5,59 m2
CHAMBRE 1	11,09 m2
CHAMBRE 2	9,07 m2
SALLE DE BAINS	4,90 m2
DEGAGT.	2,70 m2
Total surface habitable	62,15 m2
Balcon	6,50 m2

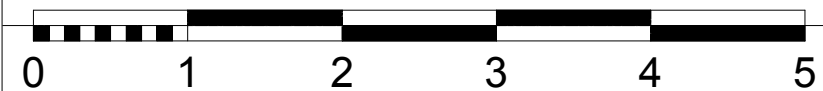

soffite ou faux plafond

document provisoire

10/07/07

